

Assembly instructions, maintenance and safety information

Batch no.



Arben Top Deck

CE UK
CA



Triclimb®



Top Deck Accessory

GB - ASSEMBLY INSTRUCTIONS, MAINTENANCE AND SAFETY INFORMATION

Suitable for ages 0+

Weight limit – 100kg

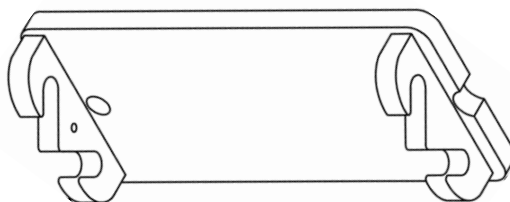

ENCOURAGE – ENHANCE – ENGAGE

Congratulations on the purchase of your Triclimb accessory. We hope that your children (and all the family) will have hours of fun playing with it! We would love to hear about your children's adventures and any feedback you may have. We pride ourselves on the versatility, durability and safety of the Triclimb range.

The range has been created to encourage children to be active, imaginative and creative in their play, the Tri Climber seeks to enhance balance, develop motor skills and engage both mind and muscle.

Benefits of Play: The Triclimb provides a surface designed for climbing which is intended for young children. Younger children are still developing a sense of judgement and learning the strength of their own bodies. They will be testing how far and how high they can jump and move. Their balance is still under development, and they are learning how to solve physical problems using their bodies. The Triclimb provides a chance to develop all sorts of skills appropriate to their age; climbing gives them the opportunity to test, retest and perfect their strength, coordination, self-confidence, concentration and independence.

Triclimb - Top Deck Accessory

Welcome to the Triclimb Top Deck accessory base pack! We hope this base will further inspire your children to create many play experiences.

Simply lock the Top Deck to either Triclimb base unit and suddenly you create a flat platform space that can be used in a multitude of open-ended ways. Quite apart from all the opportunities for climbing the top deck taps into children's creativity, and into their appetites for inventing imaginative play.

The Top Deck has been designed in conjunction with the Triclimb and Triclimb Pwt. It connects to both using a unique joint which simply locks to the top rungs of the Triclimb. You will not need any tools to connect the two together.

The accessory is intended to be assembled very easily. However, please read the following information carefully before assembling your accessory and keep this guide for future reference. If any components are missing or damaged, please contact Triclimb Ltd for a replacement before allowing your child to play.

CARE INSTRUCTIONS

Caring for your Triclimb product is not only essential for improving safety, but will also add years to its life for your children to play on and enjoy it as they grow.

 **WARNING:** if the checks and maintenance of the Triclimb unit are not carried out the product could overturn or otherwise become a hazard.

- *All bolts and fixings should be checked regularly and tightened if necessary.
- *It is important to check your Triclimb product for wear and damage regularly. If you are unsure as to the integrity of any component, replace it immediately.
- *We recommend that you regularly check your Triclimb product for splits, broken or cracked wood and for loose, missing or sharp-edged hardware. Replace, tighten and/or sand smooth as required prior to playing.
- *The wooden components are manufactured from FSC birch plywood and solid timber poles; they are protected with a durable child/toy-safe finish.
- *To clean, wipe with a damp cloth and mild detergent. Dry immediately. Leaving water or cleaning agent on the surface may damage the finish. Do not use abrasive cleansers.
- * Do not modify the unit. Triclimb is not responsible for any injury arising as a result of modifications made by customers to our products without our supervision, testing, or evaluation.

WARNINGS

- * It is extremely important that you read and retain the information in this **WARNINGS** section to reduce the risk of injury.
- * Warning: contains small parts – choking hazard.
- * Children must be supervised at all times while using the Triclimb product range.
- * No running, pushing or fighting.
- * Only use the Triclimb for its intended purpose. **For indoor use only**, in a domestic setting.
- * Tip over hazard - Place play-frame on a level surface.
- * Do not allow children to play on the Triclimb frame until the unit is fully opened.
- * Keep floors free of trip hazards and observe an obstacle free safety zone of at least 2m in all directions around the unit.
- * To minimize risk of injury from falling, do not install over a hard surface; a protective surface should be used.
- * Never allow children to play with ropes, clotheslines, pet leashes, cables, chains or cord-like items when using this play-frame or to attach these items to the play-frame.
- * Never allow children to wear loose fitting clothing, ponchos, hoods, scarves, capes, necklaces, items with draw-strings, cords or ties when using Triclimb products.
- * Do not allow children to wear open toe or heel footwear like sandals or flip-flops whilst climbing.
- * Do not permit rough play or use of equipment in a manner for which it was not intended. Jumping from the top, elevated rungs could be dangerous.
- * Observe capacity limitations of your play-frame - 1 user maximum.
- * Recommended age: 0 months – 5 years
- * Weight limit – 100kg
- * Not suitable for children under 36 months until fully assembled – fall hazard and small parts – choking hazard.
- *Risk of entrapment when folding. Never allow children to open and close the frame – ensure the thumb screws are secure both in the open position and the folded position. **WARNING** – periodically check thumb screws to make sure they are securely in place.

 **WARNING: ADULT ASSEMBLY IS REQUIRED – USE UNDER ADULT SUPERVISION**

ASSEMBLY GUIDE

CONTENTS

- A – Hex head Allen key x 1
- B – Screws (hex head) x 4
- C – Top Deck surface
- D – Deck joint

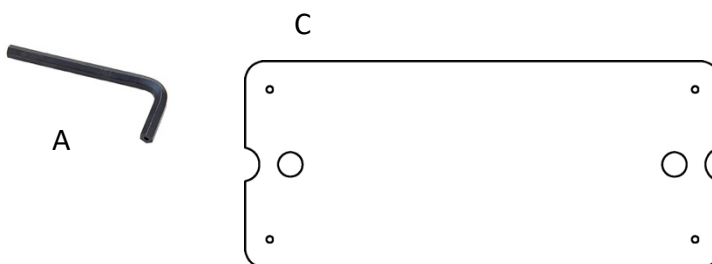

Tools needed:

Hex head Allen key (provided)

Check all parts are present.

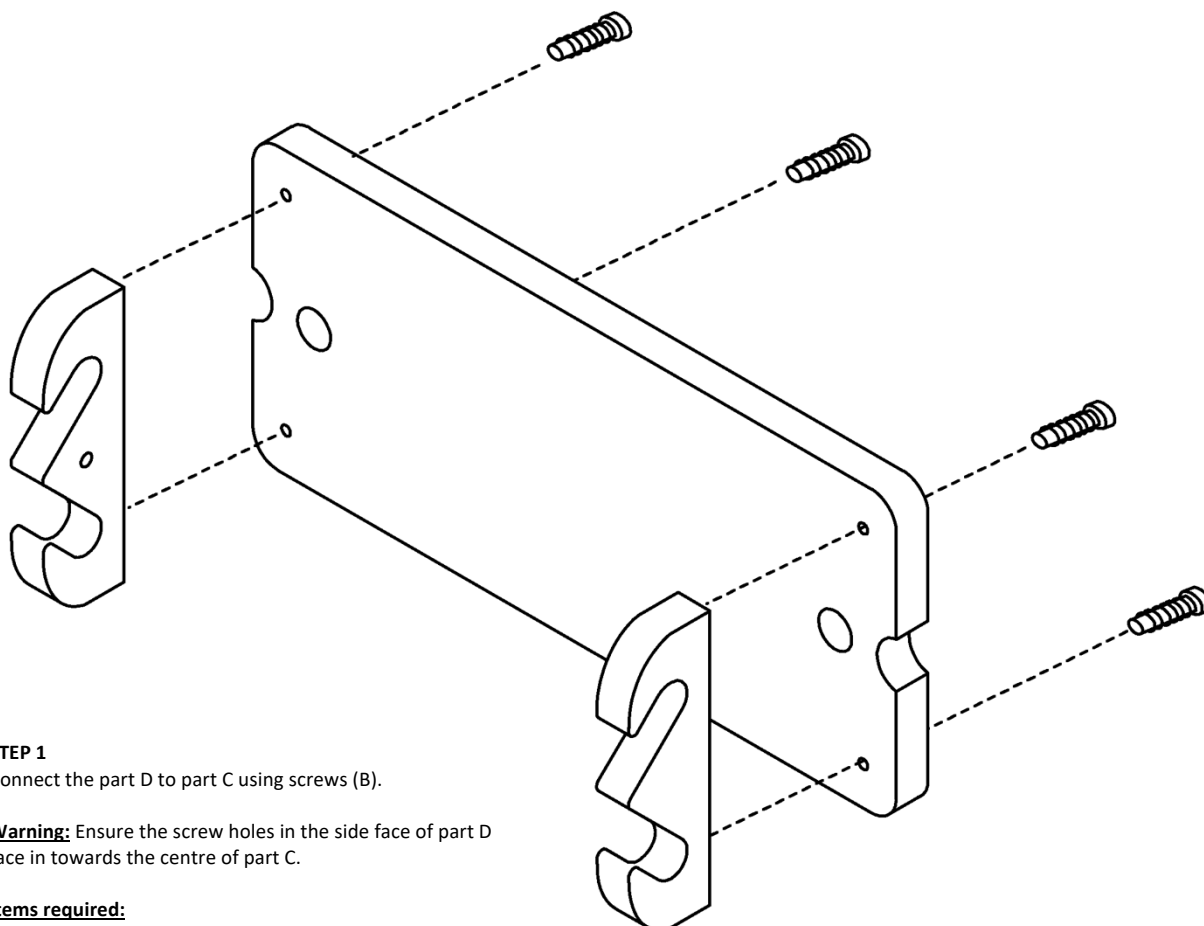
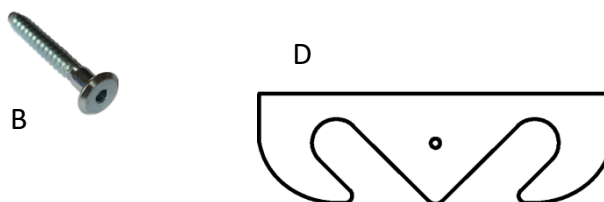

STEP 1

Connect the part D to part C using screws (B).

Warning: Ensure the screw holes in the side face of part D face in towards the centre of part C.

Items required:

- B x 4
- C x 1
- D x 2

Tip: Screw all four screws in until they are just visible – about 3mm below the bottom surface of part C.

Then locate all screws in the corresponding hole in both part D's. Turn so part D is below part C. Fully insert all four screws.

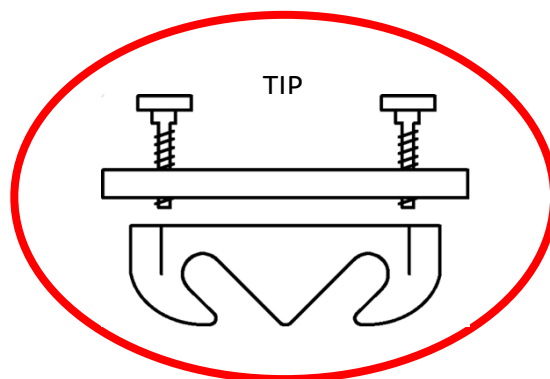

CONNECTING THE TOP DECK TO TRICLIMB/TRICLIMB PWT UNIT

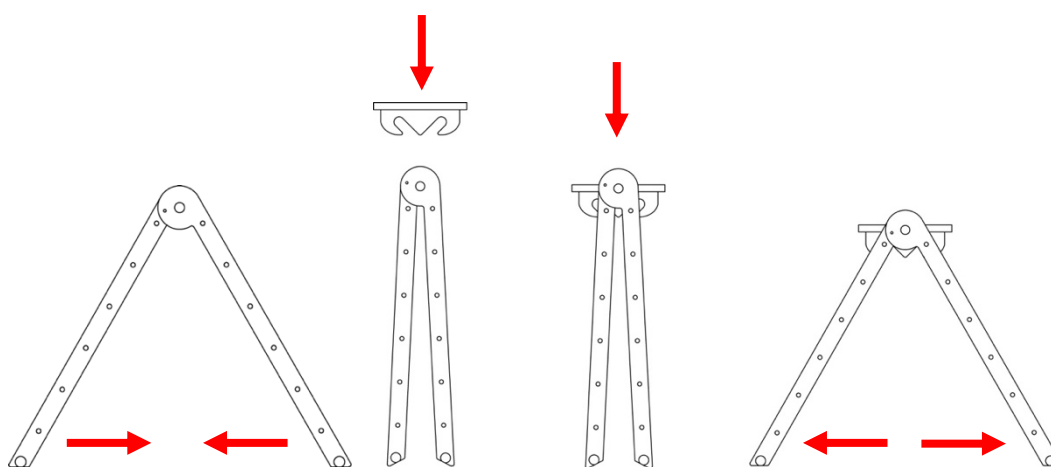

STEP 1

No tools are required. Simply close the Triclimb to almost closed.

STEP 2

Set the top deck down onto the top two rungs and push down. Tip: You may need to slightly open the legs first. The top deck will locate using the top two rungs as a guide and lock into place.

STEP 3

Once the Triclimb is fully open place the two Triclimb thumbs screws back in place.

Compatible with:

Triclimb

*When connected to the Triclimb the Top Deck is compatible with the Miri, Biri, Archi and Wibli.

Triclimb Pwt

*When connected to the Triclimb Pwt the Top Deck is compatible with the Miri, Archi and Wibli.

IPO - Registered design.
Model – TD
Designed and Manufactured by Triclimb Ltd,
Ty Gelert, Penamser Road, Porthmadog, Gwynedd, LL499NX, Wales UK

www.triclimb.co.uk hello@triclimb.co.uk

IMPORTANT! These instructions must be followed for safe assembly and use. Please retain for future Ref. 2022 V1

UKCA,EU,ASTM,CPSC,ISO,SOR tested and approved.